

Blacks Harbour

BY-LAW NO. Z.1.2

A BY-LAW TO AMEND BY-LAW Z.1, THE RURAL PLAN BY-LAW

WHEREAS the Council of the Village of Blacks Harbour deems it desirable to amend By-law Z.1, as hereinafter provided;

NOW THEREFORE THE COUNCIL OF THE VILLAGE OF BLACKS HARBOUR ENACTS AS FOLLOWS:

- 1** The Village of Blacks Harbour Rural Plan By-law Z.1 is amended by revising the use designations delineated on the Blacks Harbour Rural Plan Zoning Map constituting Schedule "A" to the Village of Blacks Harbour Rural Plan By-law Z.1, a copy of which is attached hereto as Schedule "1" with a larger scale map of that portion being amended attached hereto as Schedule "2" by changing the land use designation from Single & Two Family Residential (R-1) to Single, Two and Multi-family Residential (R-2) of the lands outlined in red on the said Schedules "1" and "2" of this by-law and which form part hereof.

- 2** The land for which the land use designation is being changed is also shown on the Service New Brunswick Digital Property Mapping System (PLANET) as PID 01218205 attached hereto as Schedule "3".

PUBLIC HEARING:

November 20, 2013

READ FIRST TIME BY TITLE:

October 16, 2013

READ SECOND TIME IN ITS ENTIRETY:

November 20, 2013

READ THIRD TIME BY TITLE AND ENACTMENT:

December 18, 2013

In Witness Whereof, Blacks Harbour has caused its corporate seal to be hereunto affixed to this By-law the 18th day of December, 2013.

TM James

Mayor

Heather Chase

Clerk

Schedule "1"

By-law Z.1, Blacks Harbour Rural Plan

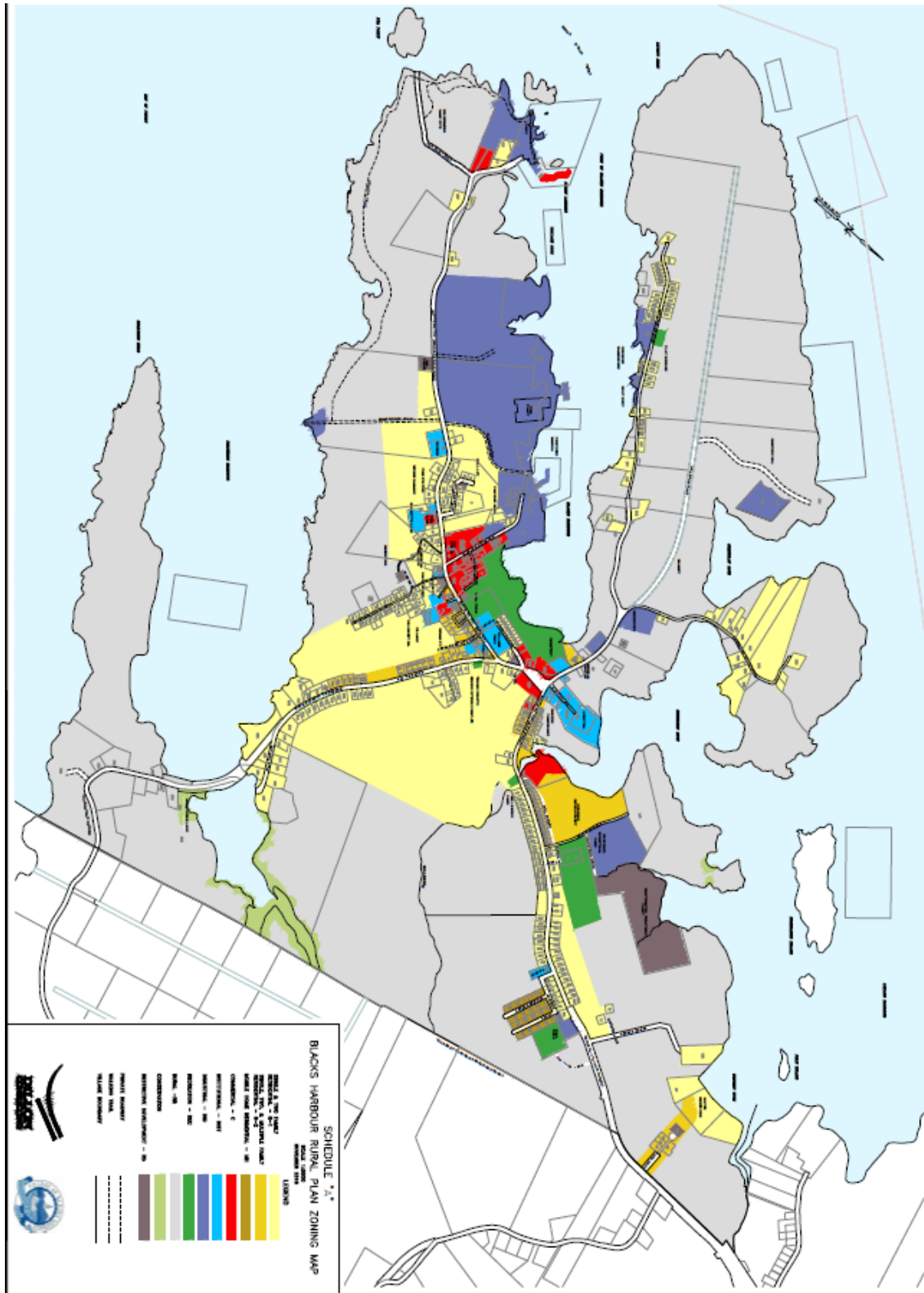

Schedule "2"

By-law Z.1, Blacks Harbour Rural Plan

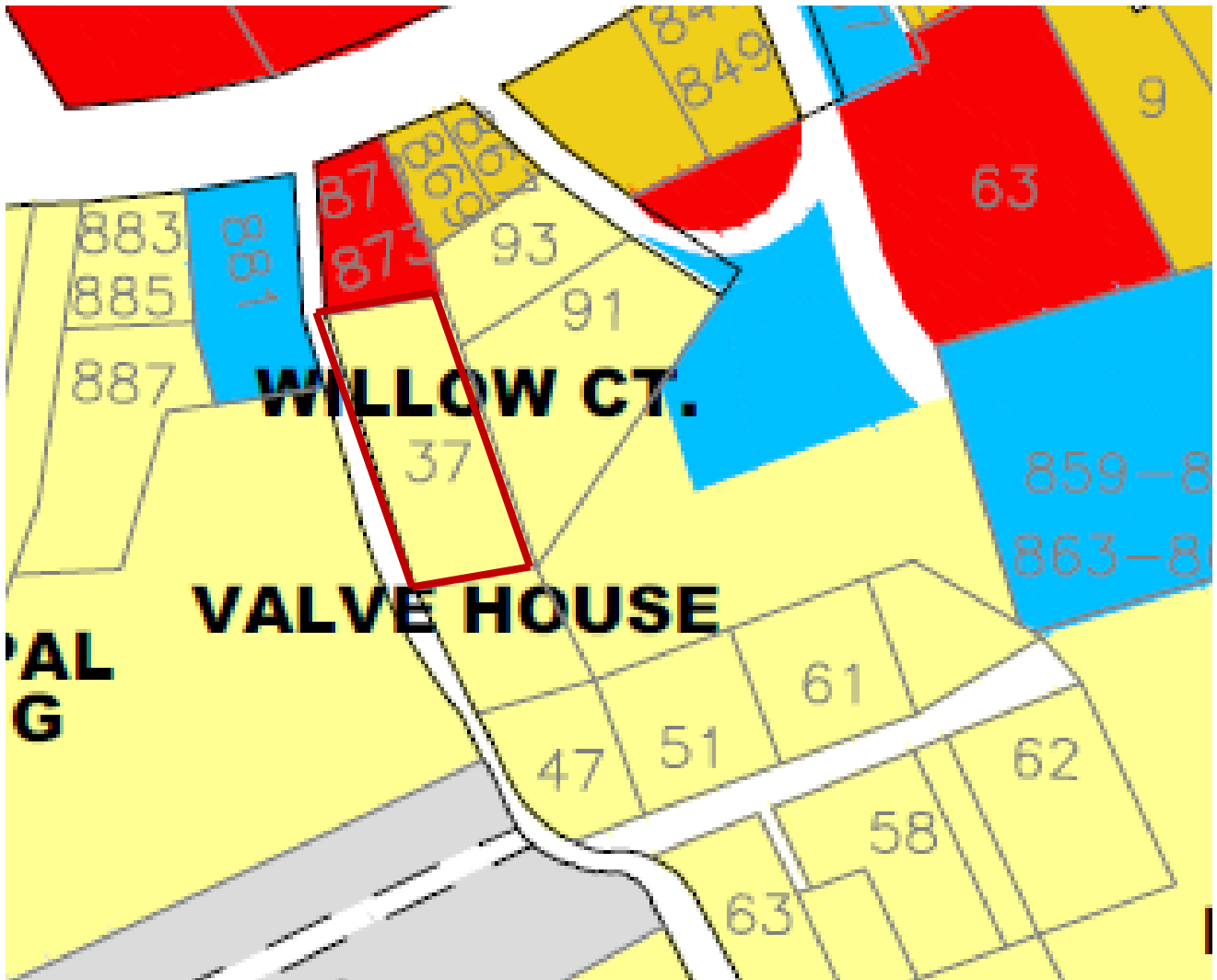

Schedule "3"

By-law Z.1, Blacks Harbour Rural Plan

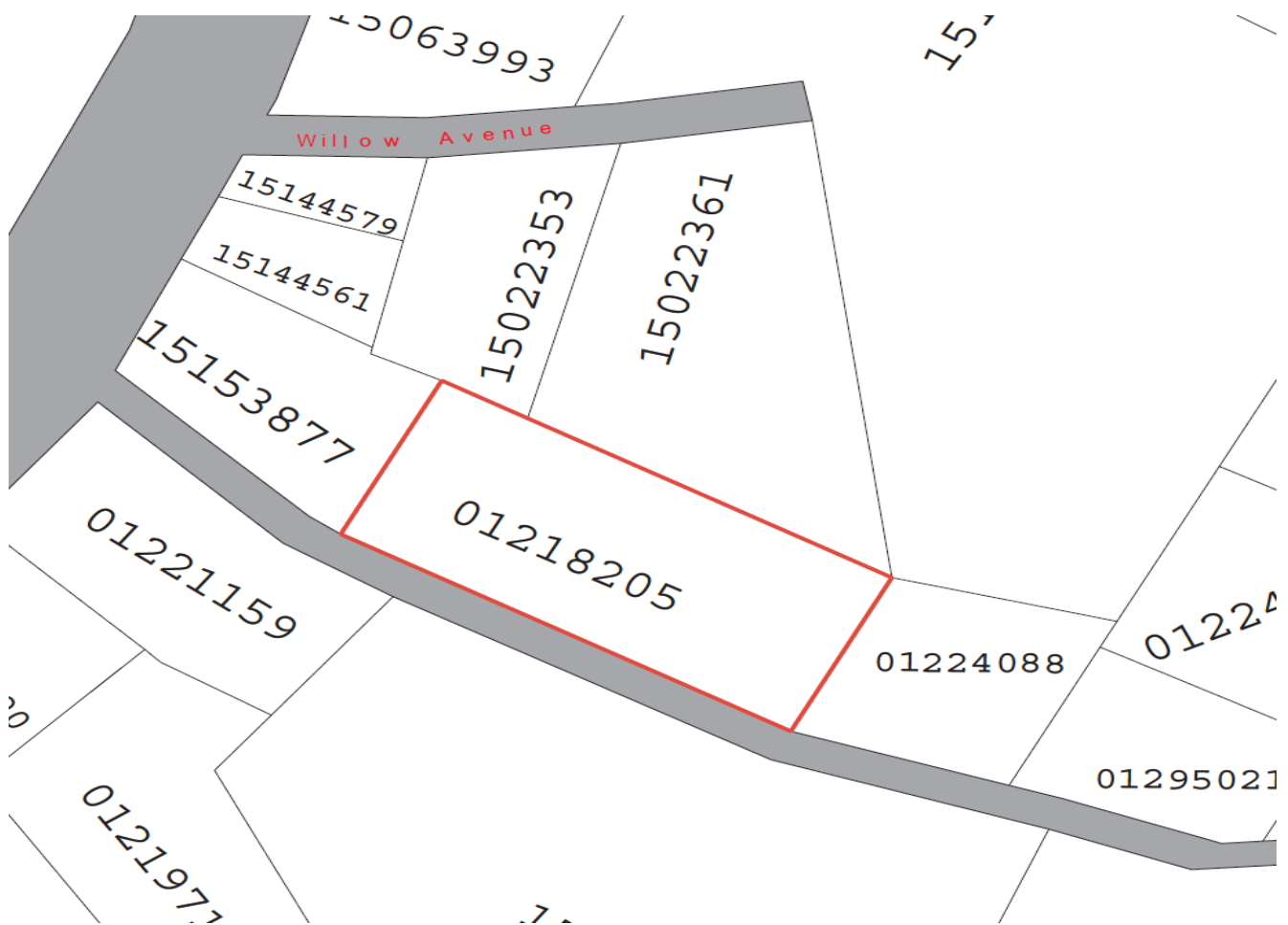

To re-zone property bearing PID 01218205, located at 37 French Village Road, an approximate total of 1338 square meters, from Single & Two Family Residential (R-1) to Single, Two and Multi-family Residential (R-2) for the purpose of a multi-family dwelling – under section 27.2 of the *Community Planning Act* and represented by the highlighted area.