

Addendum

No. TW0 Date: 7-31-2020

PROJECT:

**REROOFING VARIOUS BUILDINGS
FOR KINSTON HIGH SCHOOL
FOR
THE COFFEE COUNTY BOARD of EDUCATION
ELBA, ALABAMA**

MCKEE Project No: 2020-200

DCM NO: 2020428

The following changes and/or substitutions to the plans and specifications are hereby made a part of same and are incorporated in full force as part of the contract.

Bidders shall acknowledge receipt of this Addendum in writing on his Proposal Form.

A2.1 GENERAL MODIFICATIONS:

None

A2.2 SPECIFICATION MODIFICATIONS:

- A. Refer to Proposal Form Attachment Sheet for Unit Prices revision attached herein.
- B. Refer to **Section 09900, Painting**; This section is to be deleted from the specifications.
- C. Refer to **Section 07310, Shingles** (Architectural); Part 2-Products, Shingles. **110 mph** wind warranty in lieu of 130 mph is required.

A2.3 DRAWING MODIFICATIONS:

- A. Refer to attached drawings revised herein **dated 7-30-2020**:
 - T1.1
 - R1.1
 - R1.2

A2.4 CLARIFICATIONS

- A. New shingles are to **match** existing Building #5 and to be verified with the owner prior to installation.

END OF ADDENDUM 2

PROPOSAL FORM

UNIT PRICES - (Attachment Sheet)

Unit Prices: The Unit Prices below establishes Unit Prices so that the Owner can delete/add quantities from the Contract(s) required.

UNIT PRICE #1: The Contractor shall include in his Base Bid proposal the cost to replace approximately **100 linear feet** of existing 1x decking to match existing decking.

100 LF @ _____ per LF = \$_____ Included in Base Bid

UNIT PRICE #2: The Contractor shall include in his Alternate Bid proposal the cost to replace approximately **128 square feet** of existing plywood decking to match existing decking.

128 SF @ _____ per SF = \$_____ Included in Alternate Bid

RE-ROOFING VARIOUS BUILDINGS AT KINSTON HIGH SCHOOL FOR THE COFFEE COUNTY BOARD of EDUCATION ELBA, ALABAMA

Re-roofing Various Buildings
AT
KINSTON HIGH SCHOOL
FOR THE
Coffee County Board of Education
ELBA, ALABAMA

MCKEE and ASSOCIATES
ARCHITECTURE and INTERIOR DESIGN
631 SOUTH HULL STREET MONTGOMERY, ALABAMA 36104 (334) 834-9933

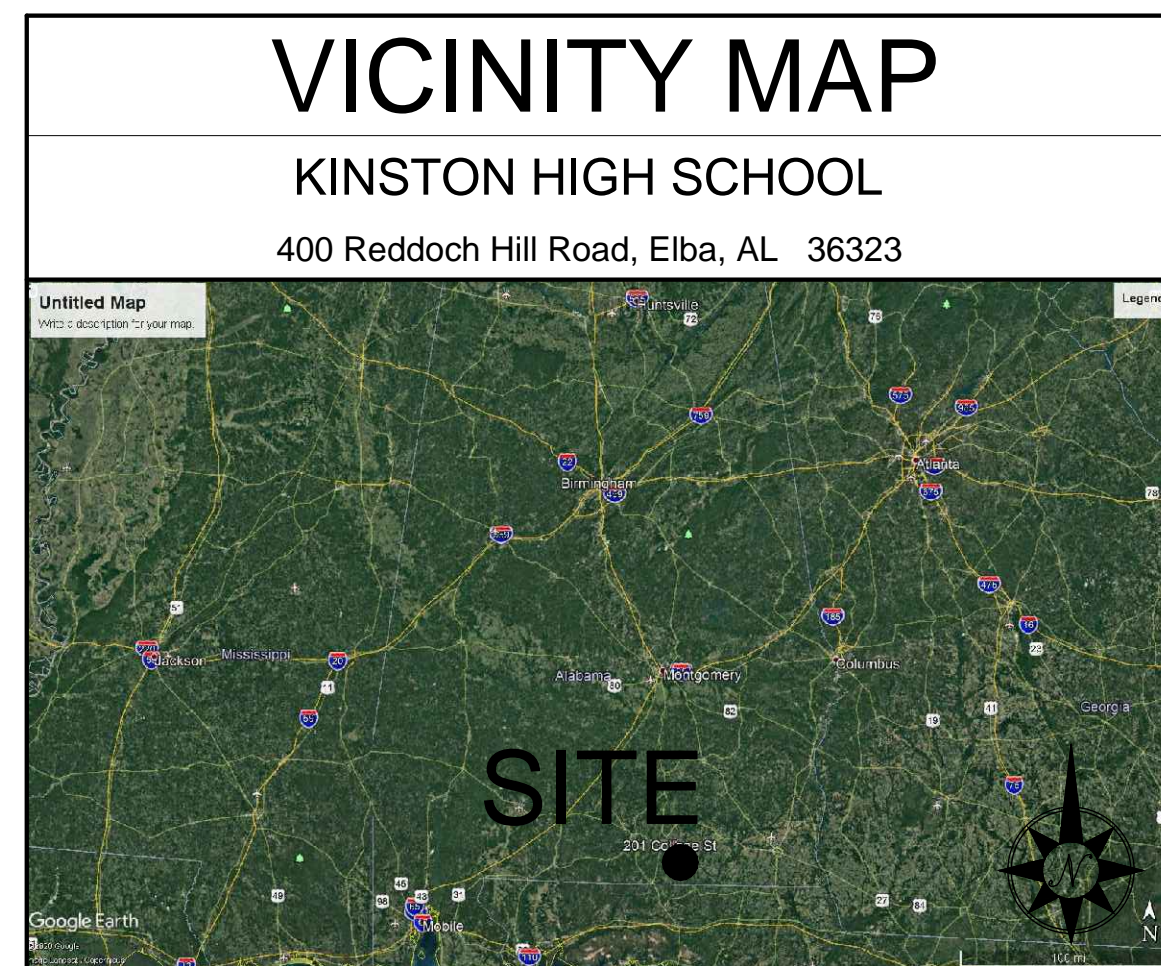

INDEX TO DRAWINGS

GENERAL	
T1.1	TITLE SHEET AND INDEX TO DRAWINGS
ARCHITECTURAL	
R1.1	ROOF PLAN BUILDING 'A' - BASE BID
R1.2	ROOF PLAN BUILDING 'B' - ALTERNATE BID
R2.1	SHINGLE ROOFING DETAILS

SHEET TITLE : COVER SHEET AND INDEX TO DRAWINGS

MCKEE JOB # : 2020-200

DRAWN BY : ks

DATE : 7-17-2020

REVISED DATE: 2 7-30-2020

REVISED DATE:

REVISED DATE:

SHEET NO. : **T1.1**

- Z:\2020\2020-2000 Recoloring Various Buildings Kinston HS Coffee CoCAD Drawings\Architectural-R1.1 Roof Plans.dwg
 - Thursday, July 30, 2020 2:13:48 PM

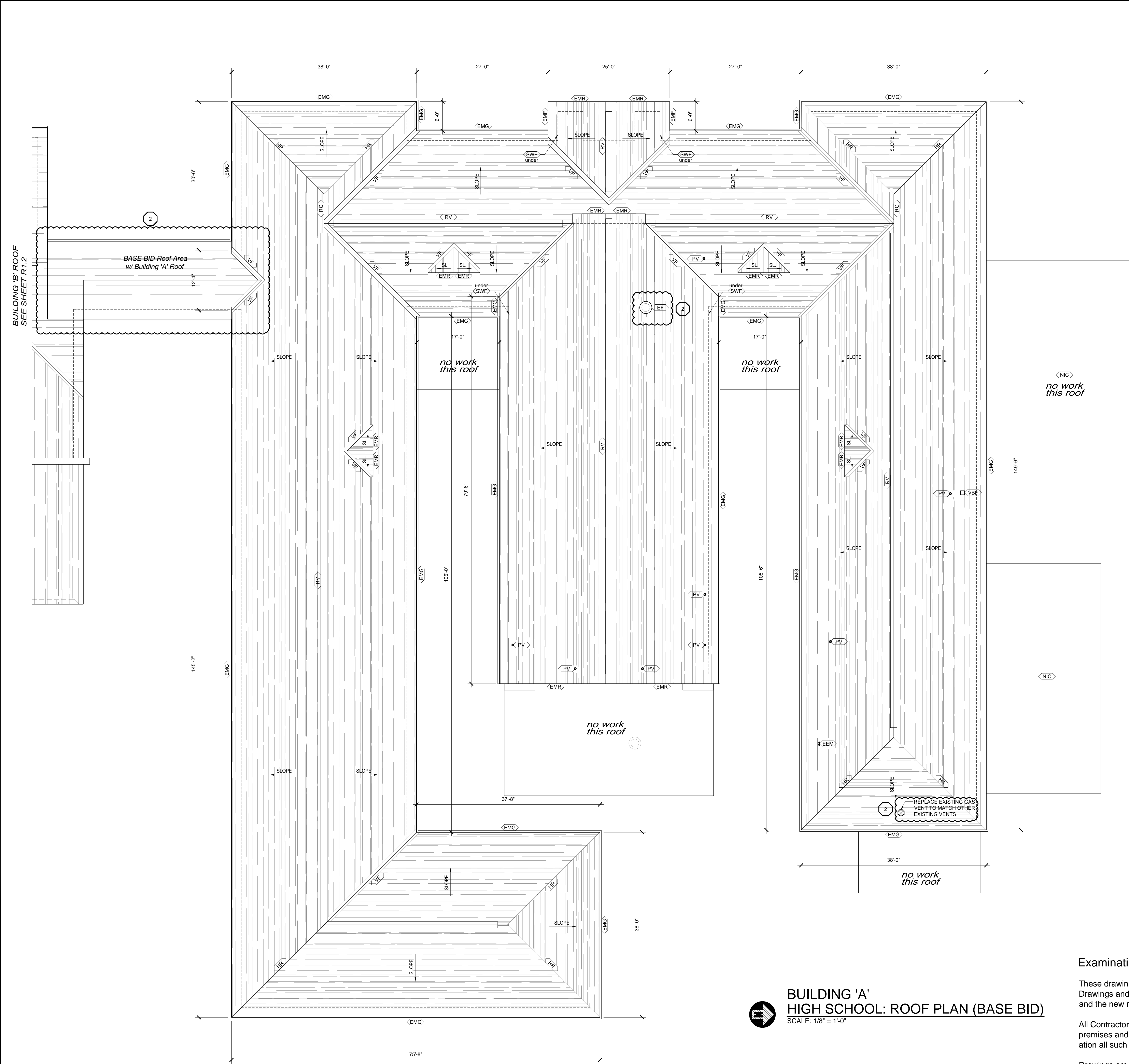

ROOF PLAN LEGEND	
SYMBOL	DESCRIPTION
<SRS>	NEW SINGLE ROOFING SYSTEM - SEE DETAILS and SPECS
<EMF>	EXISTING FASCIA
<EMG>	PROVIDE NEW DRIP EDGE
<EMR>	EXISTING METAL GUTTER (w/ DOWNSPOUTS BELOW)
<EMR>	PROVIDE NEW DRIP EDGE
<EMR>	EXISTING METAL RAKE - PROVIDE NEW DRIP EDGE
<EF>	EXHAUST FAN (IN LINE FAN ABOVE CEILING)
<FPA>	F. OMITTED IN ANCHOR LOCATION - SEE SPECS
<HR>	HIP RIDGE - SIMILAR TO RIDGE CAP
<PV>	PLUMBING VENT FLASHING THRU ROOF
<RV>	RIDGE VENT - VENTILATED
<RC>	RIDGE CAP
<RTD>	ROOF TRANSITION DETAIL
<RTW>	ROOF TO WALL FLASHING
<SWF>	SIDE WALL FLASHING
<VBF>	VENT BASE FLASHING
<VF>	VALLEY - CALIFORNIA CUT
	EXISTING ELECTRICAL MAST - PROVIDE NEW FLASHING AS REQUIRED
<NIC>	NOT IN CONTRACT

GENERAL NOTES BUILDING 'A':

1. PROPERLY FLASH ALL ITEMS THAT PENETRATE THE ROOF, WHETHER SHOWN ON ROOF PLAN OR NOT.
2. ALL METAL GUTTERS and DOWNSPOUTS ARE TO REMAIN. DRIP EDGES AND METAL EDGE STRIPS TO BE REPLACED.
3. REMOVE EXISTING SHINGLES and ROOF FELT UNDERLAYMENT TO EXISTING WOOD 1x DECKING. INSTALL NEW ROOF ROOFING SYSTEM AS SPECIFIED and DETAILED.
4. CONTRACTOR IS RESPONSIBLE FOR SECURING EXISTING MATERIAL WHICH IS TO REMAIN.
5. CONTRACTOR SHALL ORGANIZE WORK TO PROTECT BUILDING FROM WEATHER. WATER SHALL BE PREVENTED FROM ENTERING THE BUILDING DURING THE WORK. THIS SHALL INVOLVE KEEPING PENETRATIONS SEALED. PLANNING THE WORK TO REPAIR SECTIONS AND SEALING NEW TO OLD OR OTHER PRECAUTIONS OR SAFEGUARDS. DAMAGE TO OWNER PROPERTY TO BE REPAIRED OR REPLACED.
6. CLEAN UP ALL ROOF RELATED TRASH AND HAUL TO LANDFILL.
7. CONTRACTOR TO PROTECT ALL EXISTING PREFINISHED METAL GUTTERS AND DOWNSPOUTS FROM DAMAGE. CONTRACTOR TO CLEAN ALL EXISTING GUTTERS AND DOWNSPOUTS UPON COMPLETION OF ROOF REPAIRS TO ENSURE THEY ARE FREE OF DEBRIS.
8. REPLACE STEP FLASHING AND REPLACE WITH NEW AS REQUIRED.
9. REPAIR OR REPLACE ANY DAMAGED ROOF 1x DECKING AS NEEDED. REPLACE ALL EXISTING RIDGE VENTS, EAVE FLASHING, DRIPS, RAIN DIVERTERS, ETC. WITH NEW. RAIN DIVERTERS TO BE INSTALLED ABOVE EACH EXTERIOR DOOR AND EACH OUTSIDE MECHANICAL UNIT WHERE PRESENT.
10. IF REQUIRED, CONTRACTOR SHALL INSPECT THE OPENING IN THE DECKING TO RECEIVE RIDGE VENTS FOR ADEQUATE OPENING SIZE. ENSURE OPENING IS IN KEEPING WITH RIDGE VENT MANUFACTURER RECOMMENDATIONS.



Kinston High School LOCATION MAP
 NTS

BUILDING 'A' HIGH SCHOOL: ROOF PLAN (BASE BID)
 SCALE: 1/8" = 1'-0"

Examination of the Site of the Work

These drawings were compiled by the Architect from the Owner's Record Drawings and from on-site observations to indicate the building arrangement and the new roof configuration required.

All Contractors submitting proposals for this work shall first examine the premises and all conditions therein. All proposals shall take into consideration all such conditions as may affect the work under this Contract.

Drawings are dimensioned and roof penetrations shown for bidding purpose only. Contractors shall measure all existing work at the premises and verify all dimensions needed to properly interface improvements with all existing elements which are to remain.

Re-roofing Various Buildings AT

KINSTON HIGH SCHOOL
 FOR THE
Coffee County Board of Education
 ELBA, ALABAMA

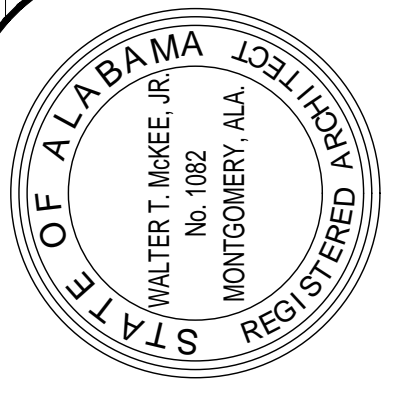

McKee and Associates
 ARCHITECTURE and INTERIOR DESIGN
 631 SOUTH HULL STREET MONTGOMERY, ALABAMA 36104 (334) 634-9933

SHEET TITLE : KINSTON HS ROOF PLAN: BUILDING 'A' (BASE BID) NTS
 MCKEE JOB # : 2020-200
 DRAWN BY : ks
 DATE : 7-17-2020
 REVISED DATE : 2 7-30-2020
 REVISED DATE :
 REVISED DATE :

SHEET NO. : **R1.1**

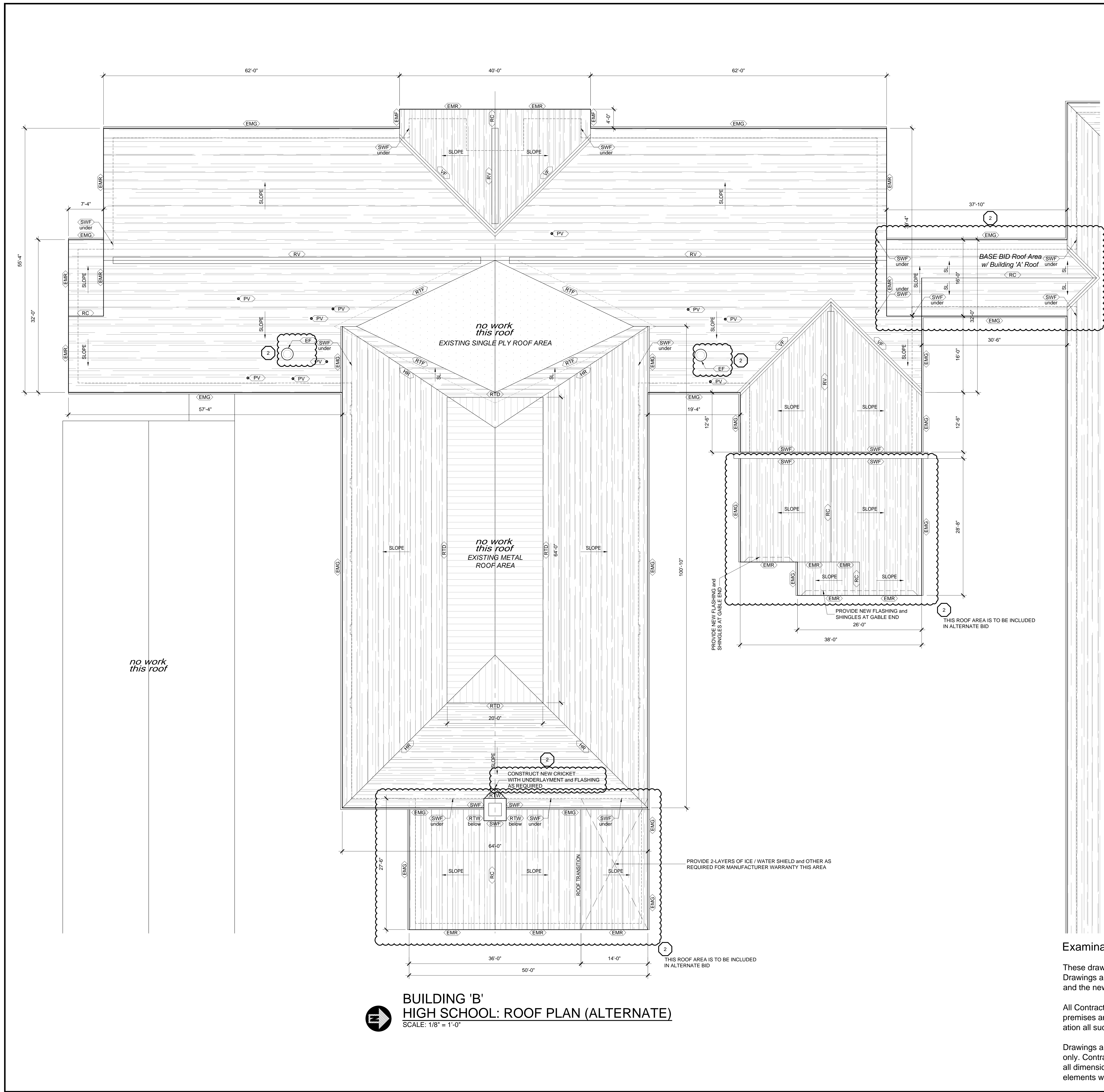

BUILDING 'B'
HIGH SCHOOL: ROOF PLAN (ALTERNATE)
 SCALE: 1/8" = 1'-0"

ROOF PLAN LEGEND	
SYMBOL	DESCRIPTION
<SRS>	NEW SINGLE ROOFING SYSTEM - SEE DETAILS and SPECS
<EMF>	EXISTING FASCIA
<EMG>	PROVIDE NEW DRIP EDGE
<EMR>	EXISTING METAL GUTTER (w/ DOWNSPOUTS BELOW)
<EMR>	PROVIDE NEW DRIP EDGE
<EMR>	EXISTING METAL RAKE - PROVIDE NEW DRIP EDGE
<EF>	EXHAUST FAN (INLINE FAN ABOVE CEILING)
<FPA>	F. OMITTED IN ANCHOR LOCATION - SEE SPECS
<HR>	HIP RIDGE - SIMILAR TO RIDGE CAP
<RV>	PLUMBING VENT FLASHING THRU ROOF
<RV>	RIDGE VENT - VENTILATED
<RC>	RIDGE CAP
<RTD>	ROOF TRANSITION DETAIL
<RTW>	ROOF TO WALL FLASHING
<SWF>	SIDE WALL FLASHING
<VBF>	VENT BASE FLASHING
<VF>	VALLEY - CALIFORNIA CUT
<RTE>	PROVIDE ROOF TRANSITION FLASHING INCLUDING ICE/WATER SHIELD (SHINGLE TO SINGLE PLY ROOF AREA PERIMETER)
<EEM>	EXISTING ELECTRICAL MAST - PROVIDE NEW FLASHING AS REQUIRED
<NIC>	NOT IN CONTRACT

GENERAL NOTES BUILDING 'A':

- PROPERLY FLASH ALL ITEMS THAT PENETRATE THE ROOF, WHETHER SHOWN ON ROOF PLAN OR NOT.
- ALL METAL GUTTERS and DOWNSPOUTS ARE TO REMAIN. DRIP EDGES AND METAL EDGE STRIPS TO BE REPLACED.
- REMOVE EXISTING SHINGLES and ROOF FELT UNDERLAYMENT TO EXISTING PLYWOOD DECKING. INSTALL NEW ROOF ROOFING SYSTEM AS SPECIFIED and DETAILED.
- CONTRACTOR IS RESPONSIBLE FOR SECURING EXISTING MATERIAL WHICH IS TO REMAIN.
- CONTRACTOR SHALL ORGANIZE WORK TO PROTECT BUILDING FROM WEATHER. WATER SHALL BE PREVENTED FROM ENTERING THE BUILDING DURING THE WORK. THIS SHALL INVOLVE KEEPING PENETRATIONS SEALED. PLAN THE WORK TO REPAIR SECTIONS AND SEALING NEW TO OLD OR OTHER PRECAUTIONS OR SAFEGUARDS. DAMAGE TO OWNER PROPERTY TO BE REPAIRED OR REPLACED.
- CLEAN UP ALL ROOF RELATED TRASH and HAUL TO LANDFILL.
- CONTRACTOR TO PROTECT ALL EXISTING PREFINISHED METAL GUTTERS and DOWNSPOUTS FROM DAMAGE. CONTRACTOR TO CLEAN ALL EXISTING GUTTERS and DOWNSPOUTS UPON COMPLETION OF ROOF REPAIRS TO ENSURE THEY ARE FREE OF DEBRIS.
- REPLACE STEP FLASHING and REPLACE WITH NEW AS REQUIRED.
- REPAIR OR REPLACE ANY DAMAGED ROOF DECKING AS NEEDED. REPLACE ALL EXISTING RIDGE VENTS, EAVE FLASHING, DRIPS, RAIN DIVERTERS, ETC. WITH NEW. RAIN DIVERTERS TO BE INSTALLED ABOVE EACH EXTERIOR DOOR AND EACH OUTSIDE MECHANICAL UNIT WHERE PRESENT.
- IF REQUIRED, CONTRACTOR SHALL INSPECT THE OPENING IN THE DECKING TO RECEIVE RIDGE VENTS FOR ADEQUATE OPENING SIZE. ENSURE OPENING IS IN KEEPING WITH RIDGE VENT MANUFACTURER RECOMMENDATIONS.

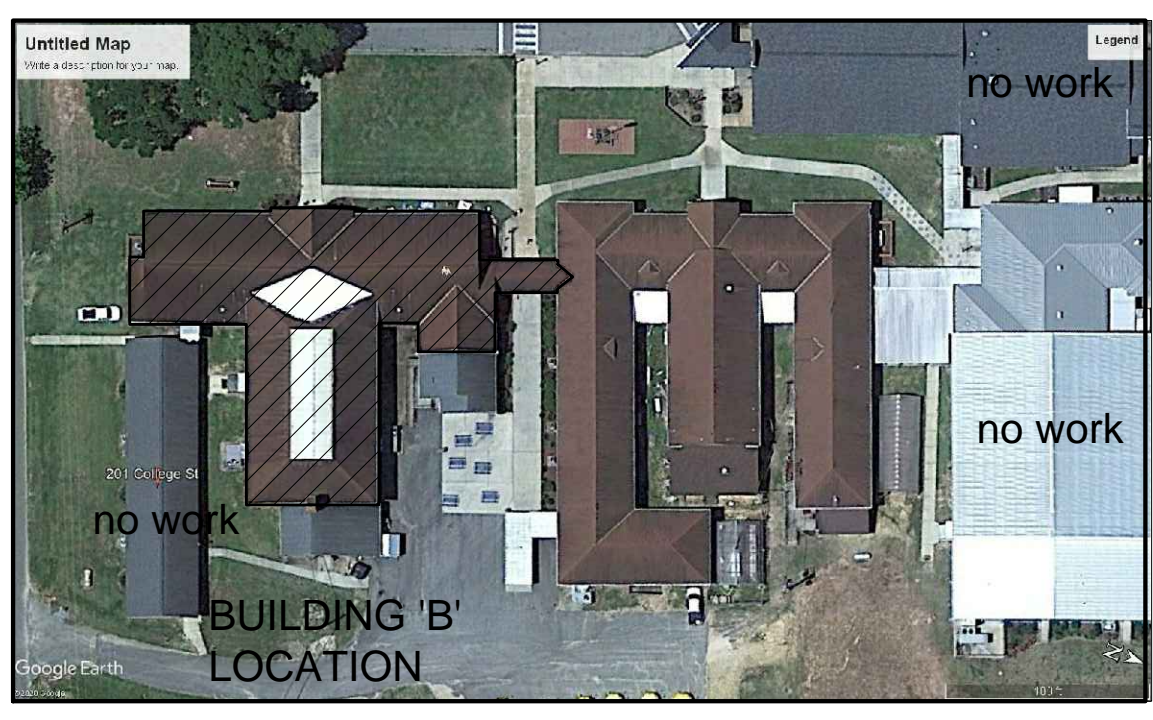

Kinston High School
LOCATION MAP
 NTS

Examination of the Site of the Work

These drawings were compiled by the Architect from the Owner's Record Drawings and from on-site observations to indicate the building arrangement and the new roof configuration required.

All Contractors submitting proposals for this work shall first examine the premises and all conditions therein. All proposals shall take into consideration all such conditions as may affect the work under this Contract.

Drawings are dimensioned and roof penetrations shown for bidding purpose only. Contractors should measure all existing work at the premises and verify all dimensions needed to properly interface improvements with all existing elements which are to remain.

Re-roofing Various Buildings
 AT
KINSTON HIGH SCHOOL
 FOR THE
Coffee County Board of Education
 ELBA, ALABAMA

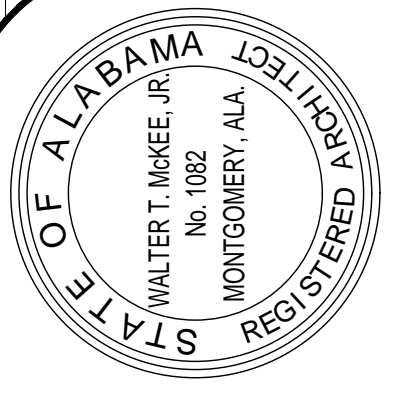

MCKEE and ASSOCIATES
 ARCHITECTURE and INTERIOR DESIGN
 631 SOUTH HULL STREET MONTGOMERY, ALABAMA 36104 (334) 634-9933

SHEET TITLE : KINSTON HS ROOF PLAN: BUILDING 'B' (ALTERNATE) NTS

MCKEE JOB # : 2020-200

DRAWN BY : ks

DATE : 7-17-2020

REVISED DATE : 2 7-30-2020

REVISED DATE :

REVISED DATE :

SHEET NO. : **R1.2**